

Homa

Homa Appliances Co., Ltd.

Add: No.54 North Dongfu Rd, Nantou,
Zhongshan, Guangdong, China, 528427.

Tel: +86 760 2313 6888/+86 760 2313 6880



Instagram



LinkedIn



Youtube

Homa

GUANGZHOU TRAVEL GUIDE

TRAVEL WITH FUN



#GOGREEN
SCAN FOR THE DIGITAL VERSION

HOMIACARE

FOREWORD

It is true that “...OLD woods best to burn, OLD wine to drink, OLD friends to trust...”.

But sometimes “With the NEW discovery comes NEW strength and NEW thoughts.”

With our team’s CARE and SHARE aspiration, here are the selected NEW & BEST of GUANGZHOU custom-made guides.

We are delighted to welcome you, by presenting these guides that are designed to help you to explore the best NEW of Guangzhou especially in recent 3 years.

Our guides cover a variety of fun places to go in Guangzhou. Whether you’re looking for tourist attractions, bars & pubs with live gigs, exhibitions or museums, our guides have got you covered.

We hope that our guides will help make your trip a memorable one.



TABLE OF CONTENT

 <u>Bar</u>	01-08
 <u>Nature Area</u>	09-13
 <u>Museum</u>	14-18
 <u>Shopping mall</u>	19-22
 <u>Exhibition & Concert in April</u>	23-27

Light - Hotel Indigo Guangzhou Haixinsha

Category: Bar



Address: No. 32 Linjiang Road,
Haixinsha East Square,
Tianhe District, Guangzhou
Contact: +86 020 3861 1888
Open Hours: 18:00-00:30

Introduction

A rooftop bar true to its name, "LIGHT" enjoys a bond with Guangzhou's skyline. Here, amidst the rich cultural vibe and enchanting beauty, you can take command of the view over the Canton Tower and the Pearl River while enjoying your favourite drink. The bar features regular live jazz and blues band performances.



Flow - Hotel Indigo Guangzhou Haixinsha

Category: Bar

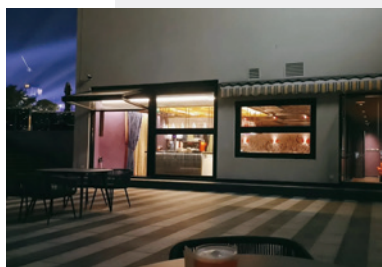

Address: No. 32 Linjiang Road,
Haixinsha East Square,
Tianhe District, Guangzhou
Contact: +86 020 3861 1888
Open Hours: 11:00-23:00

Introduction

FLOW, a dazzlingly trendy bar created in tribute to the coming-together of the Liede River and Pearl River, is a vibrant hotspot that's ideal for guests to gather and enjoy spirited get-togethers in "the neighborhood" with an excellent selection of specialty drinks and snacks.



Hope and Sesame - MiaoQianBingShi Speakeasy and Jazz Bar

Category: Bars & Clubs, Jazz Bars, Piano Bars



Address: No.58 West Miaoqian Street,
Yuexiu District, Guangzhou
Contact: +86 188 1935 3461
Open Hours: 19:00 - 01:00

Introduction

Also known as MiaoQian Bing Shi, Hope & Sesame is the first speakeasy cocktail bar in Guangzhou. Tucked away behind a traditional Cantonese cafe in the quaint neighbourhood of Dongshan Kou, the bar is a unique testing ground for cocktail innovation. From liquid clarification and exploration of different ices to sous-vide infusions and distillation, guest will discover a wide repertoire of techniques that ultimately perfect the drink. Behind another secret door within Hope & Sesame, there is the iconic "The Jazz Room," a salon with passionate jazz players congregating nightly to perform lively tunes, and a true sanctuary even for the most discerned jazz enthusiasts.

Its menu Five Years of Hope draws on the bar's most-popular drinks since its launch. From 2016, look out for From Pablo, which features saffron-infused Mancino Rosso, pisco-infused raisins and bitters. For something a little harder, look to 2018 and Spicy Not Spicy, which uses chilli-infused rum, passion fruit, amaro and lime.



Brick Lane-Guangzhou Rosewood Hotel

Category: Bar

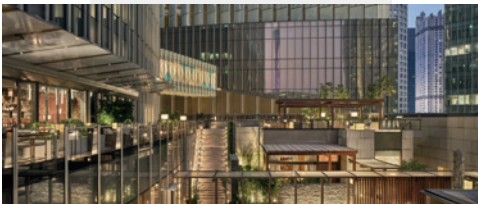

Address: No.6 East Zhujiang Road,
Tianhe District, Guangzhou
Contact: +86 20 8852 8888
Open Hours: Sunday to Monday,
Wednesday to Thursday, 18:00 -
00:30
Friday and Saturday, 18:00 - 01:30
Dress Code: Smart Casual

Introduction

A cosmopolitan setting, Brick Lane offers a bar, brewery, wine bar, hibachi grill and large outdoor terrace, making it a sought-after venue for social affairs. A carefully curated drinks list offers an array of tipples with live entertainment.

The hotel itself, Rosewood Guangzhou is situated in Guangzhou's tallest building, the 530-meter-high Guangzhou CTF Finance Centre. The ultra-luxury hotel features 251 guestrooms and 355 Rosewood Residences, 23 of which are duplex apartments. Dining options include seven food and beverage venues: a Chinese Restaurant, bistro, bar, lobby lounge and gourmet corner and, on the 107th floor, a contemporary, cosmopolitan restaurant and a sky bar with cigar humidor area and fully equipped wine corner and cellar, incorporating both indoor and outdoor spaces.



JoJo's Riverside

Category: Pub,Fusion,Gastropub



Address: Party Pier, Guangzhou
(above Party Pier Tram station),
Guangzhou
Contact: +86 20 8977 9998
Open Hours: 17:00 - 01:00

Introduction

Set on top of the popular Party Pier, with uninterrupted 360° views over The Canton Tower, The Pearl River, Lide Bridge, The CBD and Wanshengwei, JoJo's Riverside is the place to be. We've got a fantastic menu suitable for dining or for enjoying our world class cocktail list and extensive beer selection.



Hooley's Irish Pub and Restaurant

Category: Irish Bar, Pub



Address: Shop 101, No.8 Xingsheng Road, Zhujiang New Town, Guangzhou
 Contact: +86 20 3886 2675
 Open Hours: 16:00 - 02:00

Introduction

Hooley's Irish Pub & Restaurant is an authentic Irish pub with a focus on live music performances (rock, pop, folk and jazz). They serve pub grub, Irish, Italian and fusion dishes - also bake our own bread. They have a great rocking vibe from Wednesday-to-Sunday. They also have Salsa and Trivia nights during the week. They are located 10 minute taxi from the Garden Hotel; walking distance from W, Jumeirah and Rit-Carlton Hotels in Zhu Jiang New Town. An authentic Irish pub with a focus on live music performances (rock, pop, folk and jazz) Serves up pub grub, Irish, Italian and fusion dishes - also bakes its own bread.



Highland Whisky Bar

Category: Bar

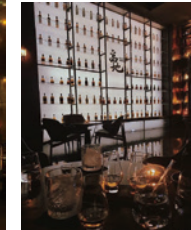

Address: Shop 101, Block 4, Xinghui Yunjin, No.4 Huacheng Road, Tianhe District, Guangzhou
 Contact: +86 20 8776 0200
 Open Hours: 18:00 - 02:00

Introduction

HIGHLAND WHISKEY BAR is located in the bustling Zhujiang New Town. The dazzling exterior wall of the whiskey bottle is a bit mysterious, which makes people full of curiosity about the space inside. Pushing the door open, what greets the eye is a wall of more than ten meters high composed of 164 bottles of whiskey. Many out-of-stock whiskeys on the market are treasured in HIGHLAND.



Guangzhou Cultural Centre

Category: Point of Interest & Landmark



Address: No.288 Middle Xinjiao Road, Haizhu District, Guangzhou
 Contact: +86 20 2883 2896
 or +86 20 2883 2897
 Open Hours: 09:00 - 17:30 (closed on Monday), no admission after 16:30

Introduction

An antique architectural complex on the northeast side of Haizhu lake - the new venue of the Guangzhou Cultural Center which will be put into use soon. Situated at the southern end of the city's central axis, this venue was designed as a Lingnan-style garden. The buildings are scattered around the Haizhu lake like stones and assembled into various courtyards, forming a layout of "a garden within a garden". Meanwhile, the typical landscape elements of the Lingnan region, "mountains, rivers, fields, and ponds", are integrated into the design of the venue.

Furthermore, the center integrates public performances, training, exhibitions, creation, research and exchanges, protection and inheritance of intangible cultural heritage, and other functions, which will become a landmark of Guangzhou.



Haizhu Wetland

Category: Nature Area



Address: No.168 Middle Xinjiao Road,
Haizhu District, Guangzhou
Contact: +86 20 8963 8182
Open Hours: 09:00 - 17:00

Introduction

Haizhu Wetlands Park is located in the Southeast of the Haizhu region and is a rare example of urban wetlands. The park is divided into three major areas. The Haizhu Lake section is combined with a water conservancy project. The first phase of the wetlands is a combination of wetland scenery and Lingnan waterside town culture with characteristic Lingnan arches and ear houses. The second stage focuses on the original wetland ecology, creating a bird paradise on the foundation of the original orchard.



Shamian Island

Category: Historic Sites

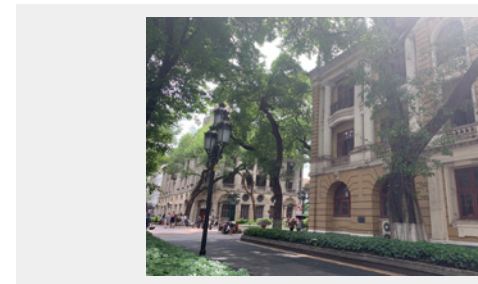

Address: No.53-54 North Shamian Street, Liwan District, Guangzhou
Open Hours: All day

Introduction

This lovely, tree-lined neighborhood bordering the Pearl River was once home to foreign merchants, and today is a laid-back area ideal for strolling or stopping for a meal or cup of tea.



Lingnan Impression

Category: Points of Interest & Landmarks



Address: West Ring Road, Guangzhou
Higher Education Mega Centre, Panyu
District, Guangzhou
Contact: +86 20 8450 8106
Open Hours: 09:00 - 18:00

Introduction

Worthwhile attraction for those interested in the Guangzhou culture and arts. This park is filled with beautiful traditional buildings that are worth exploring.



Guangdong Museum

Category: Speciality Museums



Address: No.2 East Zhujiang Road, Zhujiang New Town, Tianhe District, Guangzhou

Contact: +86 20 3804 6886

Open Hours: 09:00 - 17:00

Introduction

Guangdong Museum is a first-rate provincial museum in China, containing 166,000 items, including calligraphy, paintings, ceramics, woodcarvings, and gemstones. Covering an area of 67,000 square meters (721,182 square feet) in Tianhe District Guangzhou, it looks like a jewel box from the outside with five floors above ground and one floor below. There are five permanent exhibitions in the museum: Guangdong History and Culture, Chaozhou Gilded Woodcarvings, Natural Resources, Ceramics, and Duan Inkstones.



Yongqingfang

Category: Historic Sites



Address: No.99 Enning Road, Liwan District, Guangzhou

Contact: +86 20 8100 8663

Open Hours: 09:30 - 22:00

Introduction

Yongqing Fang is located in the center of Guangzhou old town, Enning Road, Liwan District. It's a successful combination of old town and modern design. The most famous attraction here is the "ancestral house of Bruce Lee".

The Enning road used to be the economic center of southern China when the port opened during the Qing Dynasty. It was called "Xiguan" in the past. After 1950s, Enning road has experienced a huge recession and lost its prosperity. It looked desolated. Luckily, government took it important and included it to the old city renovation plans in 2017. The main street is redeveloped as the cultural street and become the popular travel spot of Guangzhou again currently. The new style restaurants, shops and creative cultural studios in this street, and the old style residential houses in that street. It's a good combination of old and new tone.



Su · Xieying Art Museum Dongshanhu Park

Category: Speciality Museums



Address: No.1 Middle Island, Dongshanhu Park, Donghu Road, Yuexiu District, Guangzhou
Contact: +86 138 2647 9478 or wechat
Open Hours: 10:00 - 18:00

Introduction

Su·Xieying Art Museum is located in the center of the Donshanhu Park. It hopes to stand in the perspective of the park and provide more parents and children with a space related to art and leisure. Therefore, compared with ordinary art museums, Su·Xieying Art Museum not only has rich art forms such as painting, music, dance, and flower arrangement, but also has children's entertainment space and light food and beverages. The condition of the site itself can also generate many salon activities, with unlimited imagination space, which is the biggest difference between it and ordinary art museums.

Kuiyuan Art Museum

Category: Speciality Museums

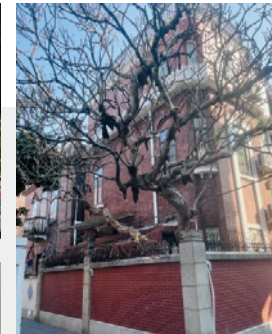

Address: Dongshankou, Yuexiu District, Guangzhou
Contact: +86 20 8765 9746
Open Hours: 11:00 - 18:00

Introduction

Kuiyuan is one of the five overseas Chinese gardens. It was built by Ma Zhuowen, an American overseas Chinese. It was built in 1922. The building is well-preserved, and it also maintains the previous red brick structure. When the Third National Congress of the Communist Party of China was going to be held at that time, a particularly inconspicuous hut was chosen. The representatives who came to Guangzhou used this building with the obvious 1922 as a reference and contact, so it gave Kuiyuan a special meaning. Kuiyuan has now been rented by several young people and opened as an art gallery. The first floor is a gallery, which holds some exhibitions from time to time, and the second floor is a high-end furniture store.





Guangzhou K11 Shopping Art Centre

Category: Shopping mall



Address: No.6 East Zhujiang Road, Tianhe District, Guangzhou
Contact: +86 40 0830 8032
Open Hours: 10:00 - 22:00



Introduction

A revolutionary museum retail concept and a mixed model of art and commerce founded by Mr. Zheng Zhigang in 2008, K11 is the world's first original brand, creating a fusion of the three basic elements of art, humanities and nature. K11 has locations in other major cities like Hong Kong, Shanghai, Wuhan, Shenyang, Tianjin.

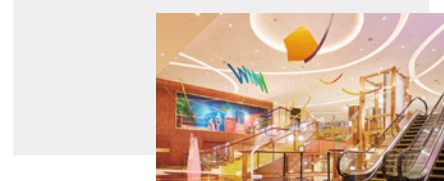

Tianhuan Parc Central

Category: Shopping mall



Address: No.218 Tianhe Road, Tianhe District, Guangzhou
 Contact: +86 20 2203 3061
 Open Hours: 11:00 - 22:00

Introduction

Tianhuan Parc Central is a new landmark of high-end shopping center in South China. The exterior buildings are designed to be the double carp fishes which have the fish scale roofs in silver mesh steel material. This project has a total building area of 110,000 square meters.

In the Tianhe Road business district, which is crowded with high-rise buildings and crowds, Guangzhou Tianhuan Parc Central is undoubtedly a unique existence. Tianhuan Parc Central is located in the core area of Guangzhou Tianhe Central Business District. It is proudly located at the focal point of Guangzhou's central axis. It integrates shopping and leisure, transportation hub and urban space. It is the first time to integrate "park" into a new design of modern shopping malls, which perfectly interprets The concept of sustainable development in which people, architecture, environment and nature live in harmony has become the most representative new commercial landmark in Guangzhou.



Yitian Holiday Plaza

Category: Shopping mall



Address: No.980 North Guangzhou Avenue, Tianhe District, Guangzhou
 Contact: +86 20 3887 5666
 Open Hours: 10:00 - 22:00

Introduction

The plaza covers a total combined floor area of 330,000 square meters, of which the commercial part occupies 120,000 square meters. It is located at the north of Guangzhou Dadao and adjacent to Meihuayuan Station of Guangzhou Metro Line 3.

The project invited JERDE, the godfather of commercial design in the world, to take "a cloud under the Baiyun Mountain" as the design inspiration, and connect the "New Central Axis of Guangzhou City". The stairs, the infinity swimming pool in the rooftop garden, the water bar leisure area, and city-level scenery extended from Baiyun Mountain, showing the tonality of "an oasis in the city".

More than 100 brands like Hoyts Cinema, blt boutique supermarket, Xiangqun Restaurant, MYFEEL, NIO, and Huawei MSC have settled in it.

EXHIBITION & CONCERT IN APRIL

Nurtured by the Same Water-Bronze Age Civilizations in the Yangtze River Basin

Category: Exhibition

Address: Guangdong Museum (No. 2 East Zhujiang Road, Zhujiang New town, Tianhe District, Guangzhou)
Contact: +86 020 3804 6886
Duration: 6th February - 2nd June
Open Hours: 9:00-17:00 from Tuesday to Sunday (closed on Monday)
Tickets: 60 RMB



Introduction

The Yangtze River basin is the mother river of the Chinese nation. With its fertile land and rich resources, it has nurtured countless Chinese sons and daughters, and also created a unique bronze cultural system with Bashu culture and Wuyue culture as the mainstay.

This exhibition brought together 137 exhibits from 18 cultural institutions in Sichuan, Chongqing, Jiangsu, Zhejiang and other provinces, including 54 first-class cultural relics, to systematically show the audience the splendid civilization of the bronze age in the Yangtze River basin, which teaches us to inherit Chinese culture and carry forward Chinese excellent traditional culture.



Screen Depth: Digital Innovation In Painting

Category: Exhibition



Address: Guangdong Contemporary Art Center (6th Floor, North Tower of Guangzhou Media Centre, No.370 Yuejiang West Road, Haizhu District, Guangzhou)
Contact: +86 020 8123 8383
Duration: 23rd March - 19th May
Open Hours: 10:00-12:00/14: 00-17: 00 from Tuesday to Sunday (closed on Monday)
Tickets: 28 RMB

Introduction

"Screen depth" focuses on a generation of artists who grew up in the visual experience of electronic screens. Different from the conventional interpretation of "screen generation" paintings, this exhibition emphasizes the depth of the screen. Depth not only shows that any artistic expression has its history, but also shows the concrete subject behind it. Therefore, the exhibition selects representative cases and sews them into the evolution history of digital innovation in the emerging painting field through careful analysis.



Mighty Ancient Zhongshan State - Treasures From The Zhongshan State

Category: Exhibition



Address: Nanyue King Museum (No.867 Jiefang North Road, Yuexiu District, Guangzhou)
Contact: +86 020 3618 2920
Duration: 15th March - 16th June
Open Hours: 9:00-17: 30 from Tuesday to Sunday (closed on Monday)
Tickets: 10 RMB

Introduction

Taking the important archaeological discoveries as the breakthrough point, the exhibition "Mighty Ancient Zhongshan State - Treasures From The Zhongshan State" comprehensively shows the brilliant achievements of Zhongshan State in politics, economy, military affairs and culture through four parts: the reappearance of Zhongshan by archaeological excavation, the ups and downs of the country and the prosperity of the country over the years, the country with thousands of rides on chariots and horses, and the eclectic rituals of the Central Plains, and makes great efforts to present the historical process of the Chinese nation and explain it in depth.



Visione Su Venezia

Category: Exhibition



Address: Jannah Art Museum (56th Floor, Jumeirah Hotel, East Plaza, Gaode Real Estate, Tianhe District, Guangzhou)

Contact: +86 20 8883 8888

Duration: 1st April - 10th May

Open Hours: 10: 00-19: 00 from

Monday to Sunday

Tickets: 49 RMB

Introduction

In Venice's doomed future, how will the world recall the city? With oriental intuition, oil painting as the main form of expression, combined with sound and installation art, the exhibition presents another imagination of Venice's past and even future in this high-altitude art museum far from the sea.

Homa